

DATA SHEET

Ø 5.25 (XL K)

ROTARY VANE VACUUM PUMPS

oil-lubricated

air-cooled

MAKE IT BECKER.

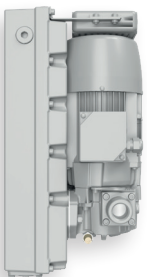

Ø 5.25 XL K

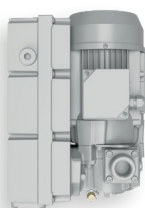

Ø 5.25



O 5.25 XL K WITH 1.0 L TANK AND OIL-AIR COOLER

- Including motors without Mate-N-Lok power connection

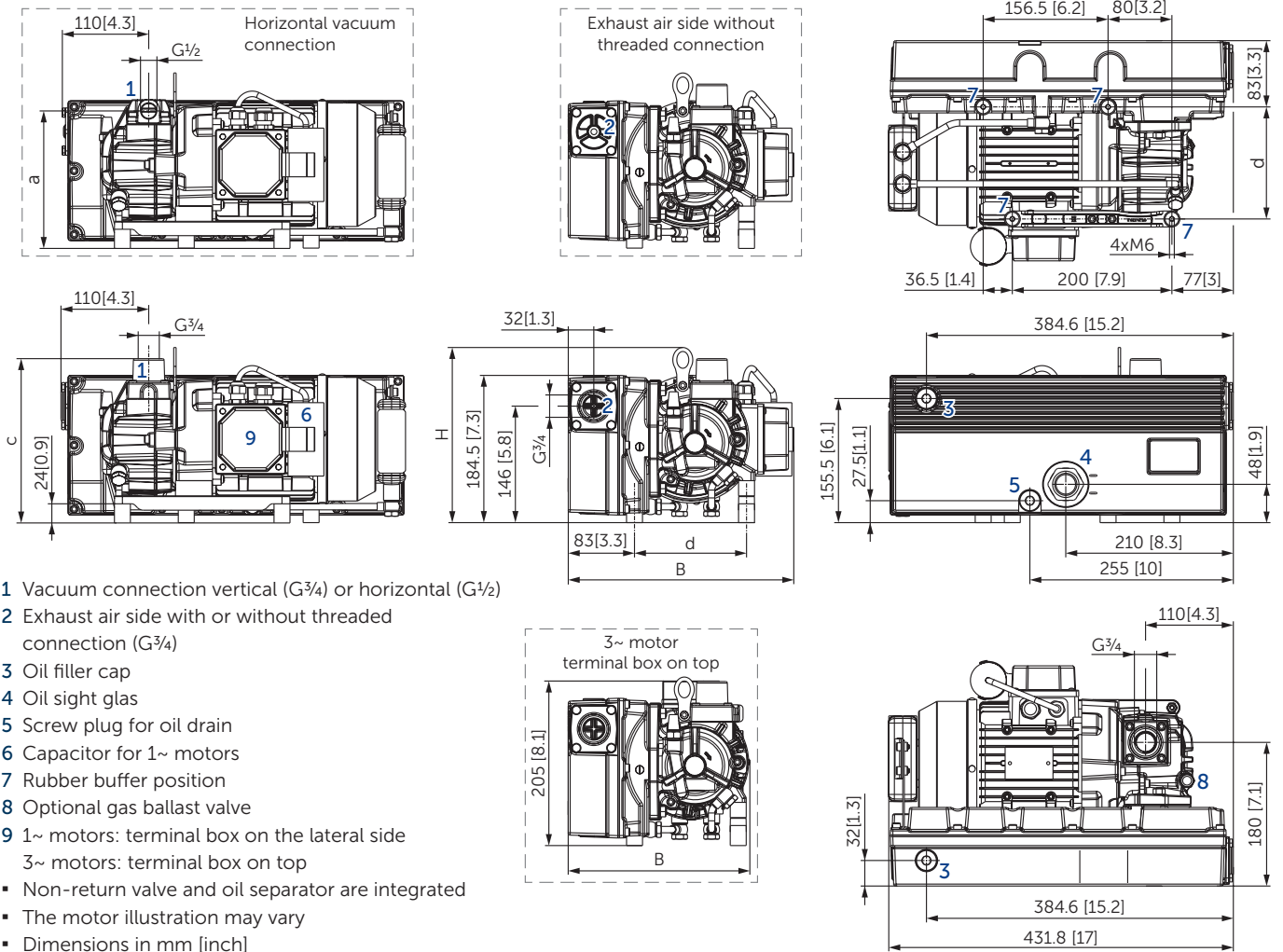

- 1 Vacuum connection vertical ($G\frac{3}{4}$) or horizontal ($G\frac{1}{2}$)
 - 2 Exhaust air side with or without threaded connection ($G\frac{3}{4}$)
 - 3 Oil filler cap
 - 4 Oil sight glass
 - 5 Screw plug for oil drain
 - 6 Capacitor for 1~ motors
 - 7 Rubber buffer position
 - 8 Optional gas ballast valve
 - 9 1~ motors: terminal box on the lateral side
3~ motors: terminal box on top
- Non-return valve and oil separator are integrated
 - The motor illustration may vary
 - Dimensions in mm [inch]

Motor	a	B	c	d	H
1~	170.9 [6.7]	282.6 [11.1]	205.9 [8.1]	140.4 [5.5]	219.4 [8.6]
3~	169.4 [6.7]	227.5 [9]	204.4 [8.1]	129.9 [5.1]	211 [8.3]

	Nominal capacity		Vacuum absolute		Emission sound pressure level ¹⁾		Weight incl. motor	Oil (Oil tank)
	m ³ /h		mbar		dB(A)			
	50 Hz	60 Hz	50 Hz	60 Hz	50 Hz	60 Hz	kg	l
O 5.25 XL K	26	30	2	2	63	63	≈24.5	1.0
O 5.25	26	30	2	2	63	66	≈22.0	0.5

¹⁾ According to DIN EN ISO 11203, accuracy class of measurement: class 2, extended measurement uncertainty: 3 dB
1 m [39.4 inch] distance, at medium load, vacuum connection piped, exhaust side open

1~ Motors										
#	50 Hz				60 Hz				Version	Weight kg
	kW	V	min ⁻¹	A	kW	V	min ⁻¹	A		
01	0.75	220–240	2800–2830	5.0–5.1	0.9	220–240	3300–3360	6.2–5.9	IP 55 • ISO F • bimetal capacitor 35 µF (450V) motor size BG 80	13.9
02	0.75	100–110	2800–2840	11.3–11.7	0.9	100–120	3250–3400	13.4–11.6	IP 55 • ISO F • bimetal capacitor 100 µF (330V) motor size BG 80	13.2

1~ Motors with Mate-N-Lok power connection										
#	50 Hz				60 Hz				Version	Weight kg
	kW	V	min ⁻¹	A	kW	V	min ⁻¹	A		
03	0.75	220–240	2800–2830	5.0–5.1	0.9	220–240	3300–3360	6.2–5.9	IP 55 • ISO F • bimetal capacitor 35 µF (450V) Mate-N-Lok motor size BG 80	13.9

3~ Motors										
#	50 Hz				60 Hz				Version	Weight kg
	kW	V	min ⁻¹	A	kW	V	min ⁻¹	A		
04	0.75	Δ230/Y400	2860	3.1/1.8	0.9	Δ265/Y460	3440	3.1/1.8	IE3 ¹⁾ IP55 • ISO F • bimetal motor size BG 71	10.6
						Δ230/Y400	3380	3.3/1.9		
05	0.75	Δ230/Y400	2860	3.1/1.8					IE3 ¹⁾ IP55 • ISO F • bimetal motor size BG 71	10.6
06	0.75	Δ200/Y350	2870	3.8/2.2	0.9	Δ200/Y350	3380	3.8/2.2	IE3 ¹⁾ IP55 • ISO F • bimetal motor size BG 71	10.6
						Δ220/Y380 Y400	3420 3440	3.8/2.2 2.2		

¹⁾ Details see type plate

• Type plate data on current consumption and rotation speed of the motors may vary. Tolerance -1.5/+2% in each case.

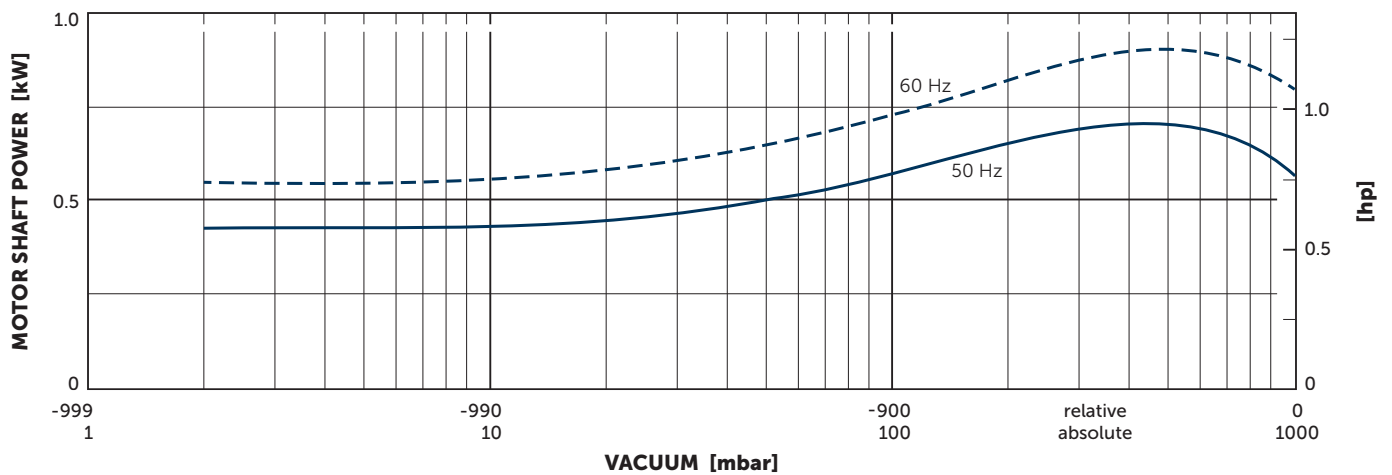
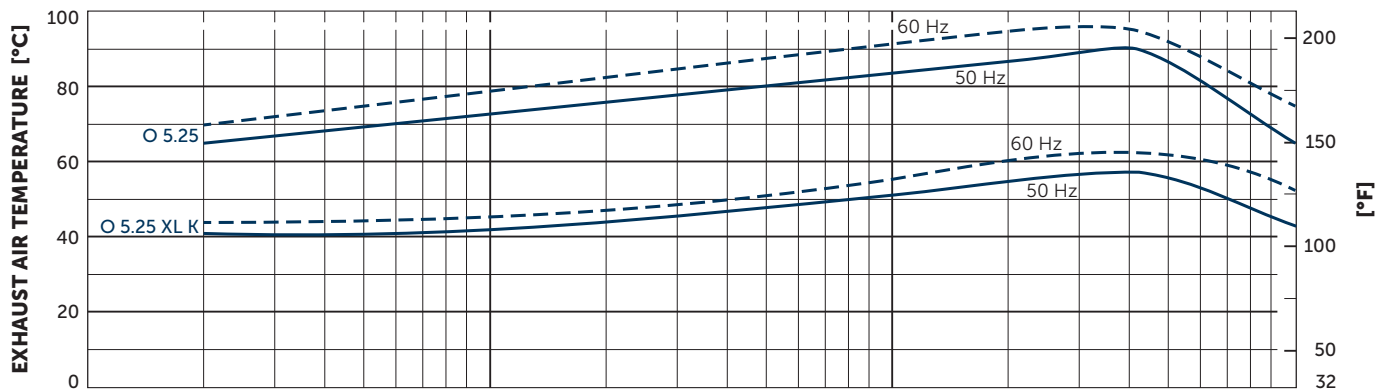
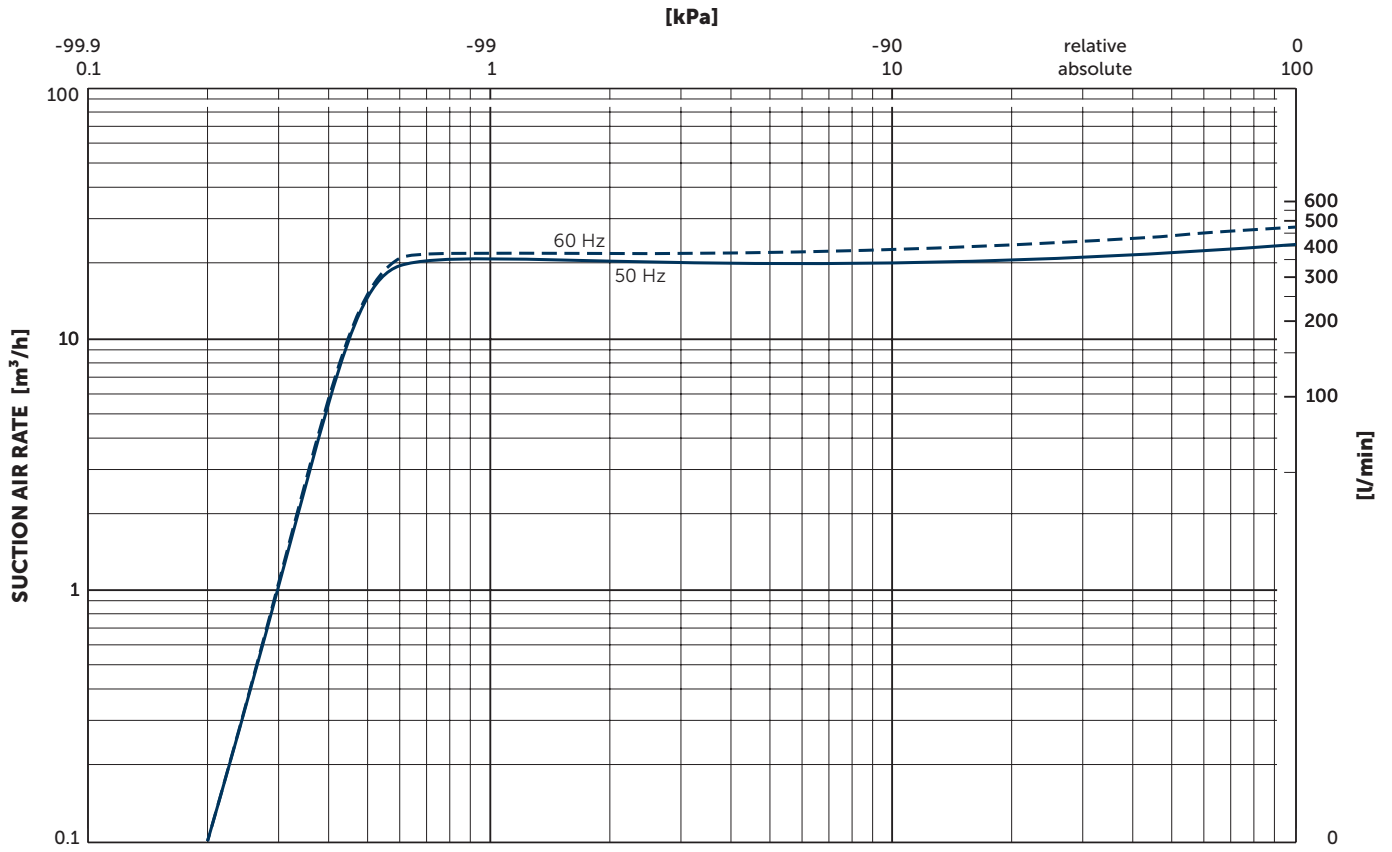

Suction air rate refers to the intake pressure
 Reference data (atmosphere): 1000 mbar (100 kPa), 20°C (68°F)
 Tolerance: ±10%

+ VARIANTS AND ACCESSORIES

O 5.25 WITH 0.5 L TANK

- Including motors without Mate-N-Lok power connection

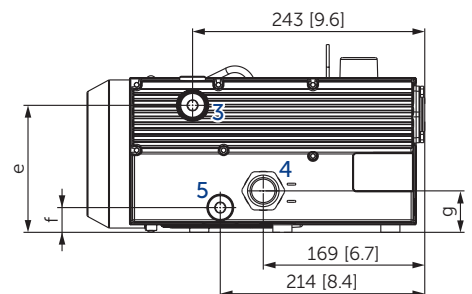
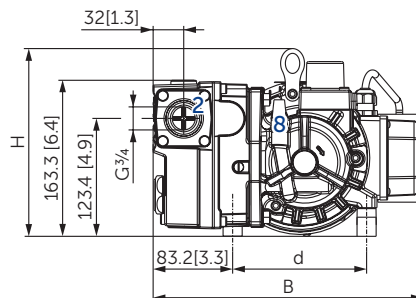
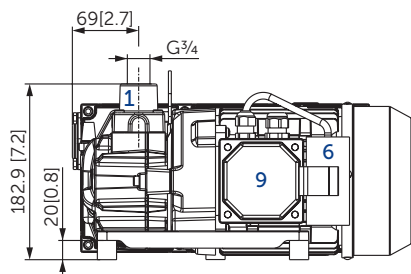
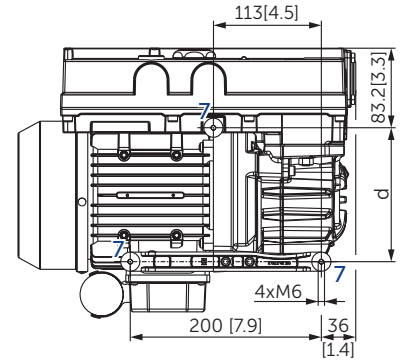
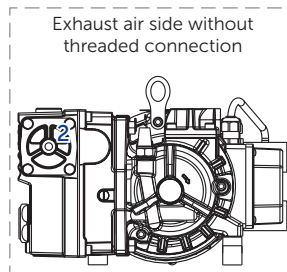
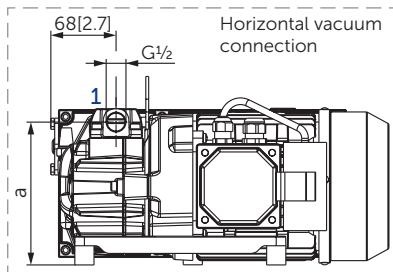

- 1 Vacuum connection vertical ($G\frac{3}{4}$) or horizontal ($G\frac{1}{2}$)
 - 2 Exhaust air side with or without threaded connection ($G\frac{3}{4}$)
 - 3 Oil filler cap
 - 4 Oil sight glass
 - 5 Screw plug for oil drain
 - 6 Capacitor for 1~ motors
 - 7 Rubber buffer position
 - 8 Optional gas ballast valve
 - 9 1~ motors: terminal box on the lateral side
3~ motors: terminal box on top
- Non-return valve and oil separator are integrated
 - The motor illustration may vary
 - Dimensions in mm [inch]

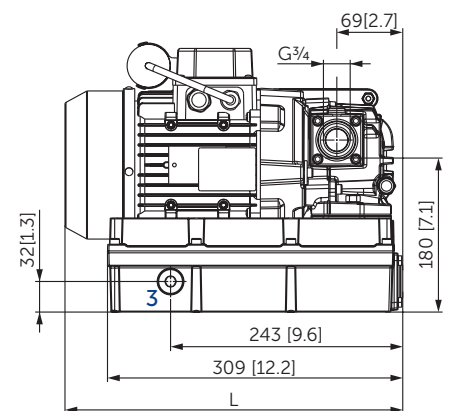
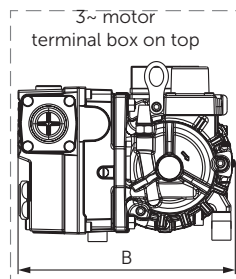

Motor	a	B	d	e	f	g	H	L
1~	148.9 [5.9]	282.6 [11.1]	140.2 [5.5]	132.9 [5.24]	25.9 [1.02]	43.4 [1.71]	196.4 [7.7]	353.5 [13.9]
3~	147.4 [5.8]	227.5 [9]	129.7 [5.1]	131.4 [5.18]	24.4 [0.96]	41.9 [1.65]	188.4 [7.4]	320.5 [12.6]

O 5.25 WITH 0.5 L TANK AND MATE-N-LOK POWER CONNECTION

- Motor #03 included

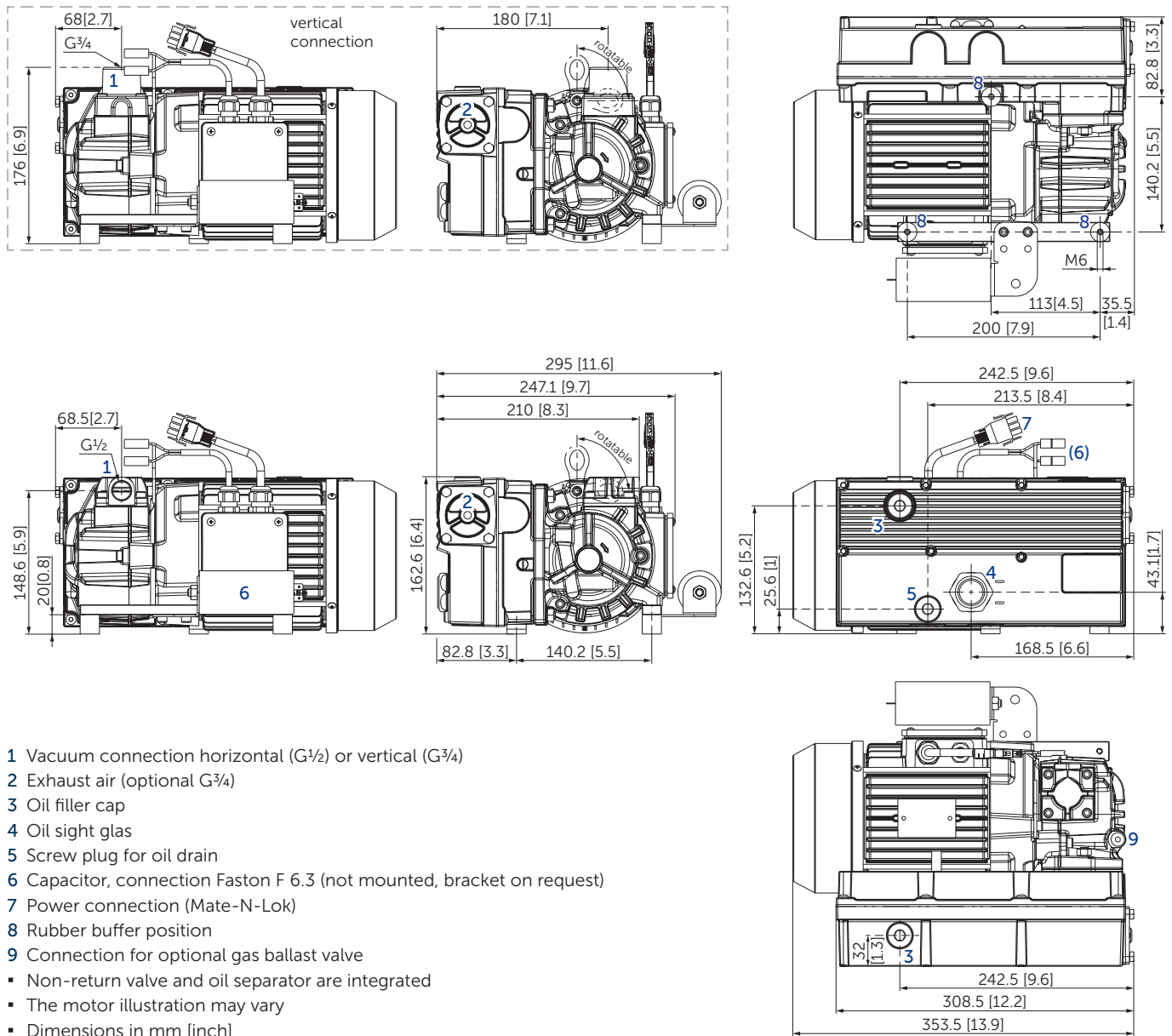

- 1 Vacuum connection horizontal (G $\frac{1}{2}$) or vertical (G $\frac{3}{4}$)
- 2 Exhaust air (optional G $\frac{3}{4}$)
- 3 Oil filler cap
- 4 Oil sight glass
- 5 Screw plug for oil drain
- 6 Capacitor, connection Faston F 6.3 (not mounted, bracket on request)
- 7 Power connection (Mate-N-Lok)
- 8 Rubber buffer position
- 9 Connection for optional gas ballast valve
 - Non-return valve and oil separator are integrated
 - The motor illustration may vary
 - Dimensions in mm [inch]

GAS BALLAST VALVE

- Version for small amounts of moisture, vacuum <3 mbar
- Version for higher amounts of moisture, vacuum <20 mbar

BECKER LUBE¹⁾

- | | | | |
|-----------------------|-------------------------|--------------------------------------|---------------------------------------|
| ▪ M 68 mineral | ▪ S 68 synthetic | ▪ SL 68 food (food packaging) | ▪ SM 68 food (food processing) |
| ▪ M 32 mineral | ▪ S 32 synthetic | ▪ SL 32 food (food packaging) | ▪ SM 32 food (food processing) |

¹⁾ See operating instructions



MAKE IT BECKER.